

Art. 91771

STRAP



IT Attacco compatibile con manubri o qualsiasi supporto simile a una barra: bicicletta, e-bike, scooter, passeggini, motocicletta, carrello da golf...

- Utilizzo consigliato da 22-35mm (max 19mm a 50 mm).
- Si adatta anche a manubri non rotondi (conici, flat o integrati), adattatore piatto incluso.
- Installazione rapida tramite banda in gomma EPDM.
- Nuovo sistema DuoLock 2.0 con sblocco rapido.
- Compatibile con tutte le custodie e accessori Optiline.

FR Fixation compatible avec les guidons ou tout support similaire à une barre : vélos, e-bikes, scooters, poussettes, motos, voitures de golf...

- Utilisation recommandée de 22 à 35 mm (max 19 mm à 50 mm).
- Convient également aux guidons non ronds (coniques, plats ou intégrés), adaptateur plat inclus.
- Installation rapide par élastique EPDM.
- Nouveau système DuoLock 2.0 avec libération rapide.
- Compatible avec tous les étuis et accessoires Optiline.

DE Halterung kompatibel mit Lenkern oder anderen stangenähnlichen Halterungen: Fahrräder, E-Bikes, Roller, Kinderwagen, Motorräder, Golfwagen...

- Empfohlene Verwendung von 22–35 mm (maximal 19 mm bis 50 mm).
- Passt auch für nicht runde Lenker (konisch, flach oder integriert), flacher Adapter im Lieferumfang enthalten.
- Schnelle Montage durch EPDM-Gummiband.
- Neues DuoLock 2.0-System mit Schnellverschluss.
- Kompatibel mit allen Optiline-Koffer und Zubehör.

EN Mount compatible with handlebars or any support similar to a bar: bicycles, e-bikes, scooters, strollers, motorcycles, golf carts...

- Recommended use from 22-35mm (max 19mm to 50 mm).
- Also fits non-round handlebars (tapered, flat or integrated), flat adapter included.
- Quick installation by EPDM rubber band.
- New DuoLock 2.0 system with quick release.
- Compatible with all Optiline cases and accessories.

ES Soporte compatible con manillares o cualquier soporte similar a una barra: bicicletas, e-bikes, scooters, cochecitos, motos, carritos de golf...

- Uso recomendado de 22-35mm (max 19mm a 50 mm).
- También se adapta a manillares no redondos (cónicos, planos o integrados), adaptador plano incluido.
- Instalación rápida mediante banda de caucho EPDM.
- Nuevo sistema DuoLock 2.0 con cierre rápido.
- Compatible con todas las maletas y accesorios Optiline.

NL Mount compatibel met stuur of elke andere ondersteuning vergelijkbaar met een stuur: fietsen, e-bikes, scooters, kinderwagens, motorfietsen, golfkarretjes...

- Aanbevolen gebruik van 22-35 mm (max 19 mm tot 50 mm).
- Past ook op niet-ronde sturen (taps toelopen, plat of geïntegreerd), inclusief platte adapter.
- Snelle montage door EPDM-elastiek.
- Nieuw DuoLock 2.0 systeem met snelsluiting.
- Compatibel met alle Optiline Telefoonhoezes en accessoires.

DuoLock 2.0

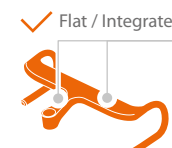

Optiline

Garanzia / Warranty



LAMPA S.p.A.
Via G. Rossa, 53/55,
46019 Viadana (MN) ITALY
Tel. +39 0375 820700
UNI EN ISO 9001:2015
Certified Company
www.optiline.it

Made in China

Orizzontale
Landscape



Verticale
Portrait



Art. 91771

STRAP

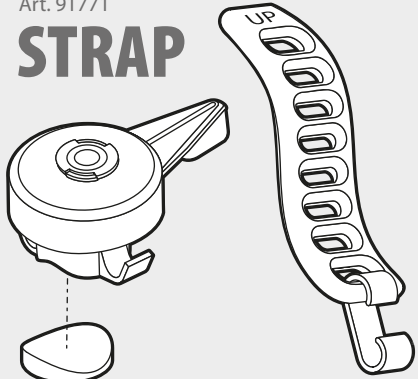

Spessore per manubri piatti
Spacer for flat handlebars

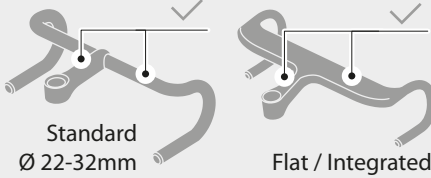

Standard
Ø 22-32mm

Flat / Integrated

Quick side release

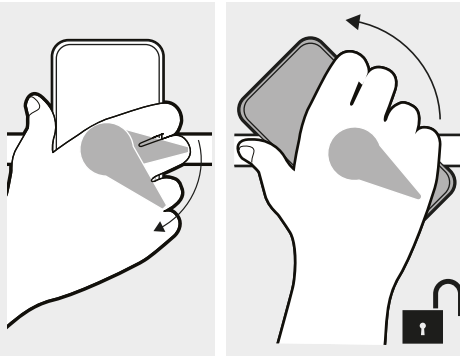
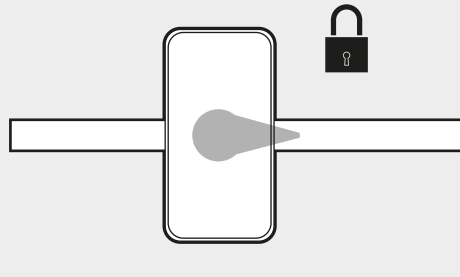

Portrait

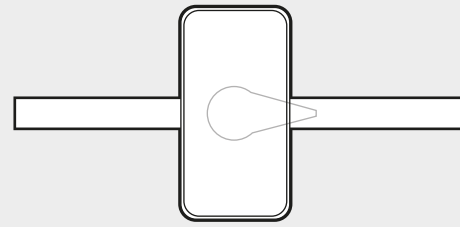

Landscape

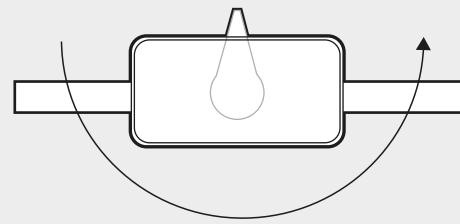

Option A

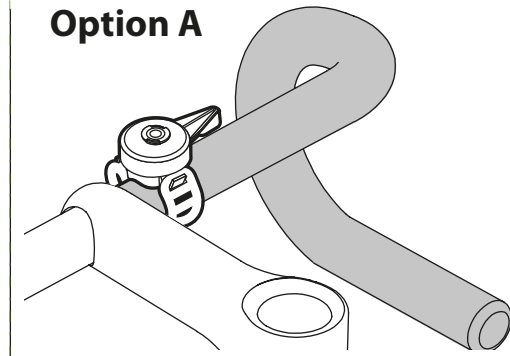

Option B

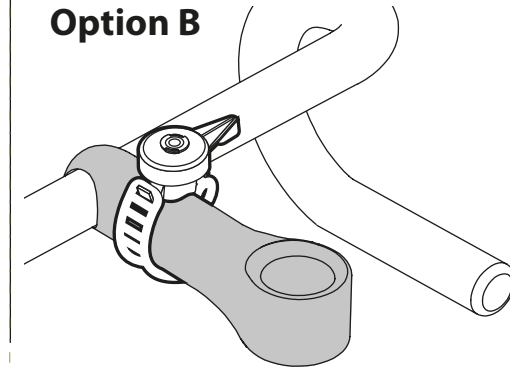

Video di installazione
Installation video



2

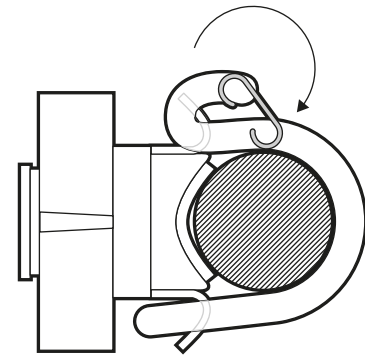

Cable organizer

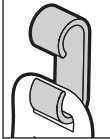

3

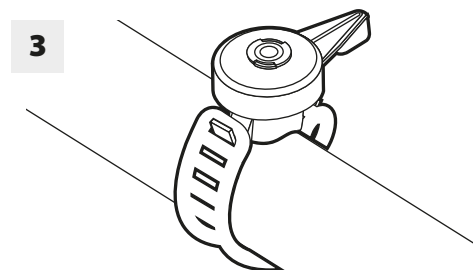

4

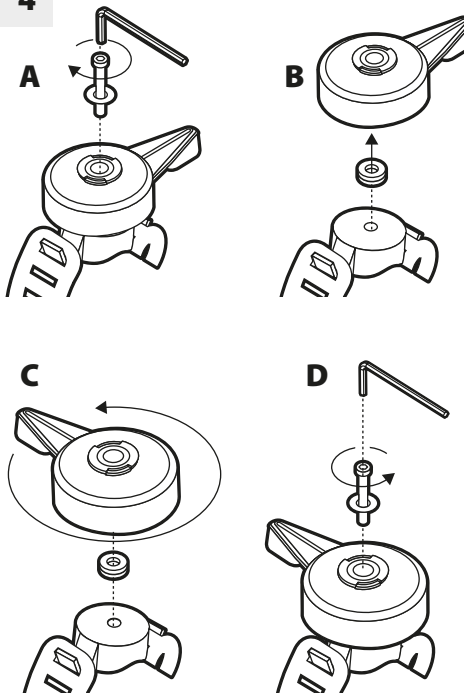

IT Il supporto può essere difficile da installare / rimuovere al di fuori della portata consigliata. Un serraggio eccessivo delle viti potrebbe danneggiare il prodotto, si prega di regolare con cautela.

EN The mount can be difficult to install / remove outside the recommended range. Over tightening the screws might damage the product, please adjust with caution.

FR Le support peut être difficile à installer/retirer en dehors de la plage recommandée. Un serrage excessif des vis peut endommager le produit, veuillez ajuster soigneusement.

ES El soporte puede ser difícil de instalar/quitar fuera del rango recomendado. Apretar excesivamente los tornillos puede dañar el producto; ajústelos con cuidado.

DE Außerhalb des empfohlenen Bereichs kann es schwierig sein, die Halterung anzubringen/zu entfernen. Zu starkes Anziehen der Schrauben kann das Produkt beschädigen, bitte sorgfältig einstellen.

NL De houder kan moeilijk te installeren/verwijderen zijn buiten het aanbevolen bereik. Schroeven kunnen losraken als gevolg van oncontroleerbare omstandigheden, controleer en draai ze gewoon vast voordat u ze installeert.