

TABELLA LED PROGRAMMABILE



Manuale d'uso

Schermo LED a colori/modifica personalizzata
Pannello dinamico con LED RGB. Il futuro è arrivato e aspetta solo te.

1- Scansionare il codice per scaricare l'APP

1-Scansionare il codice QR qui sotto per scaricare e installare l'applicazione con il cellulare, oppure accedere a Google Play/ App Store e cercare "iPixel Color" per scaricarla.



Scannerizza il QR code e scarica l'app

2-Accendere il Bluetooth.

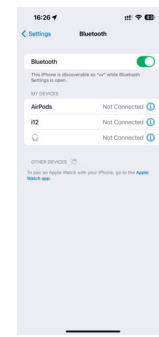

1

2- Connettere il dispositivo

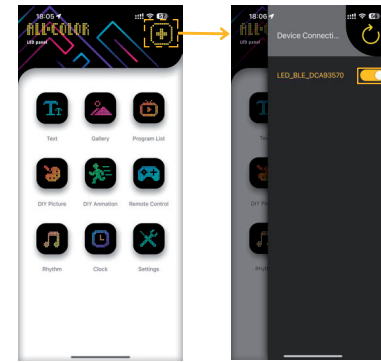

Nota:
1: quando si apre l'applicazione per la prima volta, consentire tutte le autorizzazioni.
2: fare clic sul pulsante "+" per attivare il Bluetooth.
3: se il Bluetooth non può essere cercato sul telefono, controllare se è stato attivato il GPS.

2

3- Modificare il testo

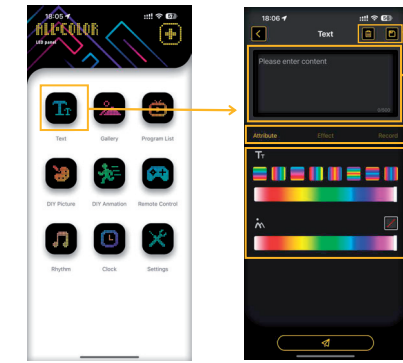

→ Cancellare/Salvare come record
→ Inserimento testo
→ Impostazione attributi, effetti speciali, inviare registro record
→ Regolare colori

3

4- Effetti speciali/registrazione

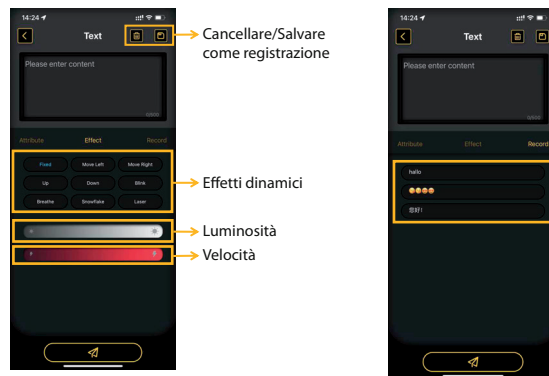

→ Cancellare/Salvare come registrazione
→ Effetti dinamici
→ Luminosità
→ Velocità

→ Registrosi salvate

4

5- Galleria

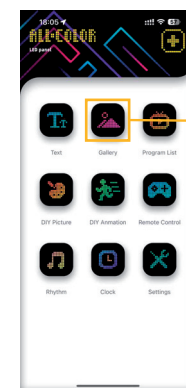

→ Vai all'interfaccia fai-da-te
→ Galleria di sistema/ immagini salvate in modalità fai-da-te

→ Immagine dinamica/ immagine statica

5

6- Elenco programmi salvati

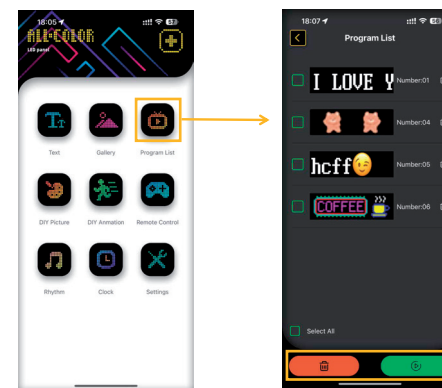

→ Elimina/Invia

6

7- Immagine fai da te

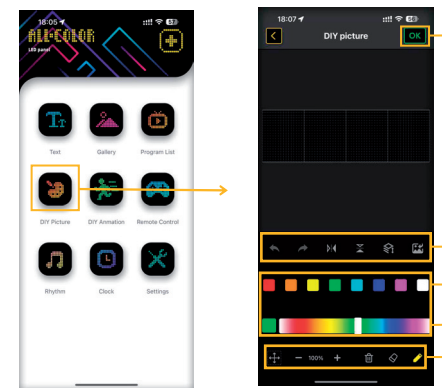

→ Salva
→ Annulla | Recupera | Specchia orizzontale | Specchia verticale | Nuovo livello | Inserisci immagine
→ Colore standard
→ Tutti i colori
→ Sposta | Regola dimensione | Elimina | Cancella | Dipingi

7

8- Animazione fai-da-te



→ Modifica fotogramma/ inserimento fotogramma
→ Modifica
→ Regola la luminosità/ regola la velocità
→ Inserisci immagine

→ Selezione

→ Anteprima

→ Cancella/ Riproduci

8

9- Telecomando

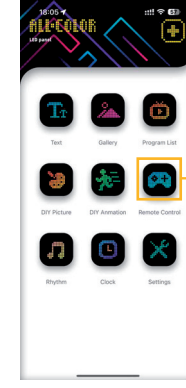

→ Interruttore

9

10- Ritmo

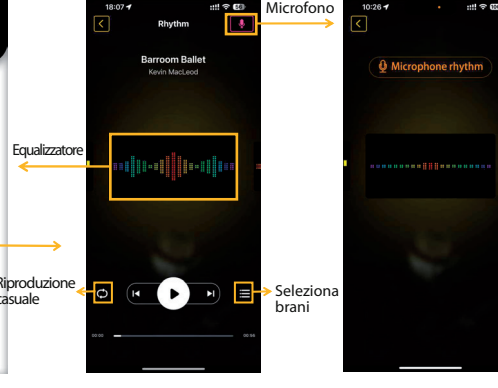
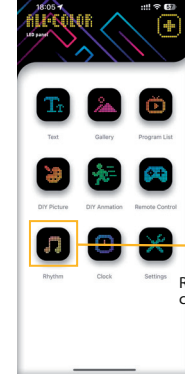

→ Equalizzatore

→ Riproduzione casuale

→ Selezione brani

10

11- Orologio

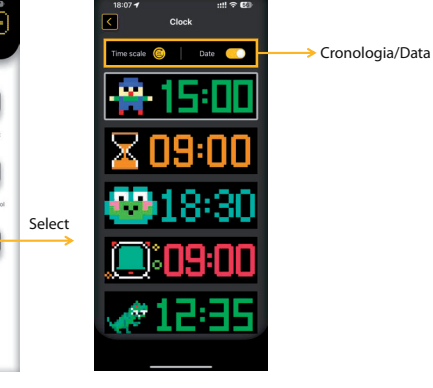
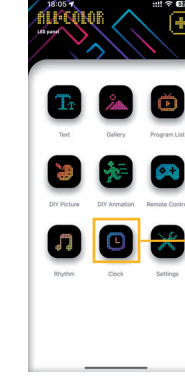

→ Cronologia/Data

11

12- Impostazioni

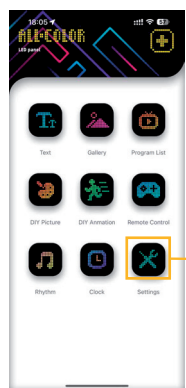

→ Selezione lingua
→ Ripristino delle impostazioni di fabbrica
→ Informazioni sui parametri del dispositivo
→ Rotazione dello schermo
→ Regolare la luminosità dello schermo
→ Numero di versione dell'app

12

13- Installazione

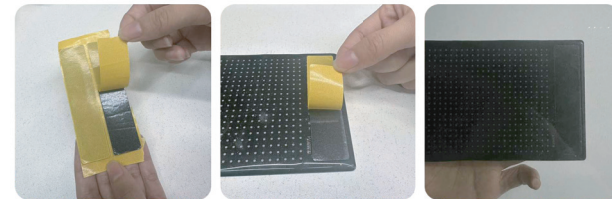

- Pulire accuratamente il retro del pannello e la superficie scelta per l'installazione, rimuovendo polvere, sporco e residui.
- Applicare il nastro biadesivo uniformemente sul retro del pannello, assicurandosi che aderisca bene su tutta la superficie.
- Posizionare il pannello con attenzione nella posizione desiderata e premere il pannello sulla superficie per circa 5-8 secondi, garantendo una buona adesione.

13

14- Accessori inclusi

- Pannello LED x1.
- Nastro biadesivo in schiuma x1.
- Cavo USB x1.
- Manuale d'uso x1.

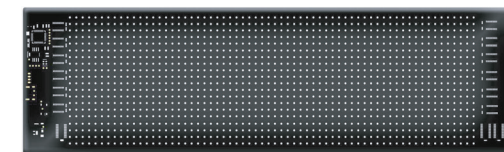

14

15- Parametri del prodotto

Materiale del prodotto: PU + FPCB
Colore del prodotto: NERO
Dimensioni: 70 x 173 mm/512 LED (**Art. 95780**)
92 x 374 mm/1024 LED (**Art. 95781**)
120 X 595 mm/1536 LED (**Art. 95783**)
Metodo connessione: Bluetooth
Alimentazione: USB
Tensione di corrente: 5V/2A



15

SMART LED PANEL



User Manual

Full color LED screen/custom editing
Dynamic panel with RGB LED. The future has arrived and is waiting for you.

1- Scan the code to download the APP

1-Scan the QR code below to download and install the app with your mobile phone or enter Google Play/App Store and search for "iPixel Color" to download



Scan the QR code and download the app

2-Turn on Bluetooth

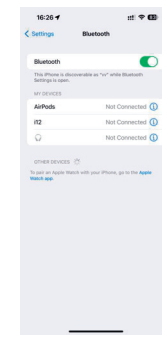

1

2- Connect the device



Note:
1: when you open the app for the first time, please allow all permissions.
2: please click "+" button to turn on the Bluetooth.
3: if Bluetooth cannot be searched on your phone, please check if you have turned on the GPS.

2

3- Text editing

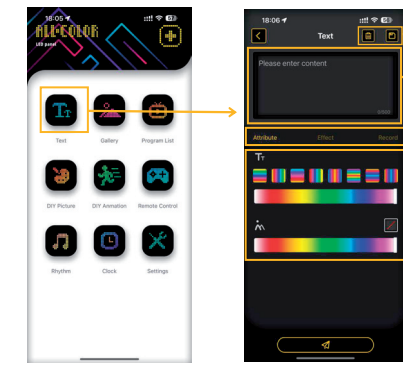

Delete/Save as record
Input text
Set attributes, special effects, send records
Adjust specific parameters

3

4- Special effects/recording

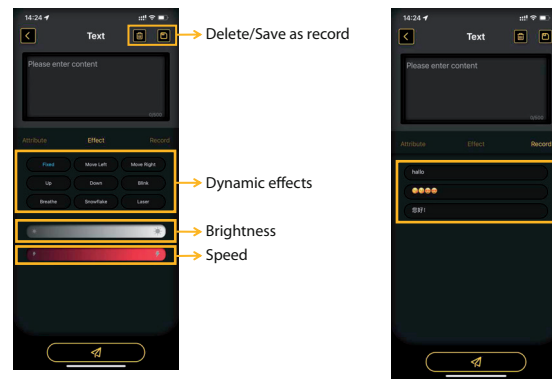

Delete/Save as record
Dynamic effects
Brightness
Speed
Saved records

4

5- Gallery

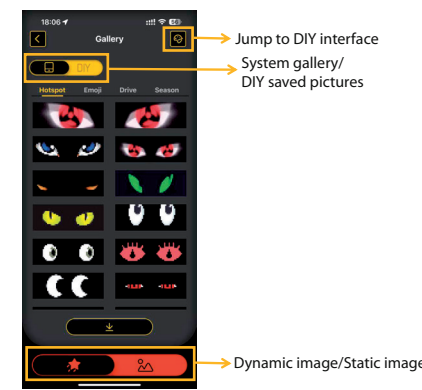
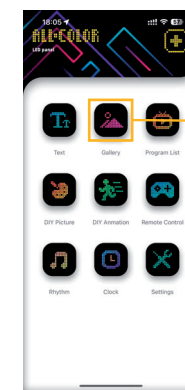

Jump to DIY interface
System gallery/
DIY saved pictures
Dynamic image/Static image

5

6- Saved programme list

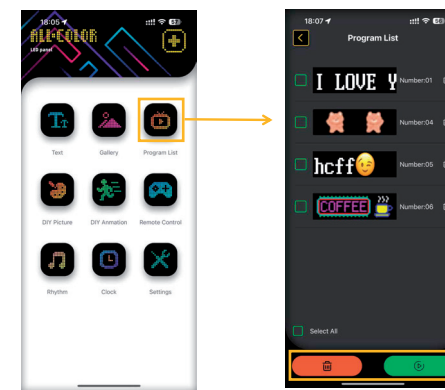

Delete/Send

6

7- DIY picture

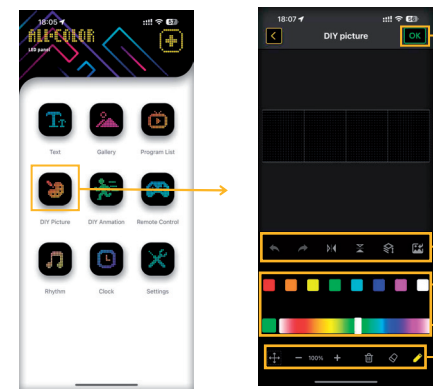

Save
Revoke | Recover | Mirror Horizontal
Mirror Vertical | New Layer | Insert
picture
Standard color
All colors
Move | Size adjusted | Delete |
Erase | Painting

7

8- DIY animation

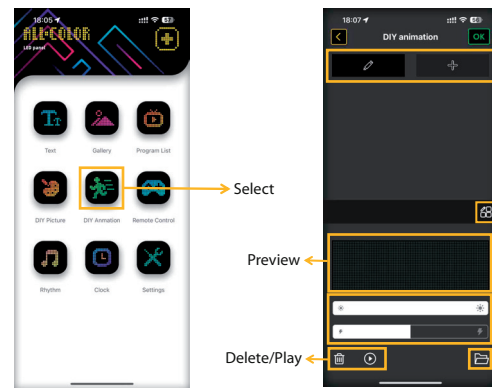

Edit frame/ insert frame
Edit
Adjust brightness/
Adjust the speed
Insert picture
Delete/Play

8

9- Remote control

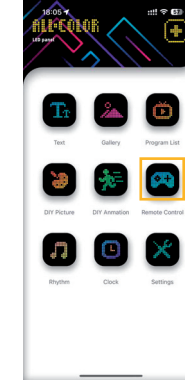

Power switch

9

10- Rhythm

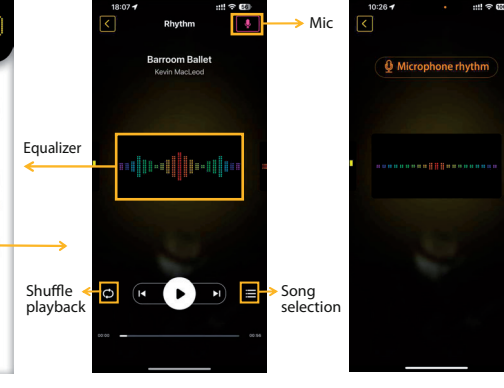
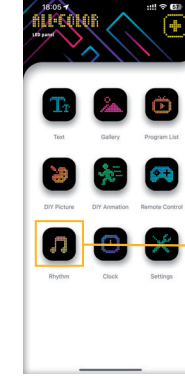

Mic
Equalizer
Shuffle
playback
Song
selection

10

11- Clock

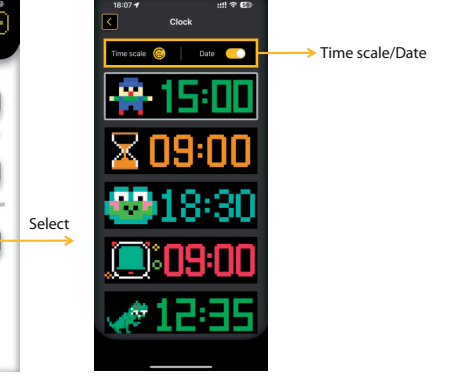
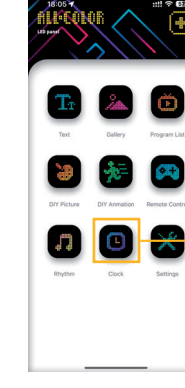

Time scale/Date

11

12- Settings

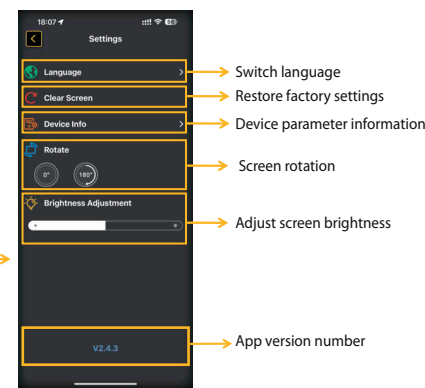
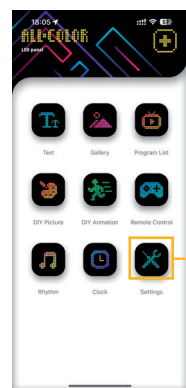

Switch language
Restore factory settings
Device parameter information
Screen rotation
Adjust screen brightness
App version number

12

13- Installation method

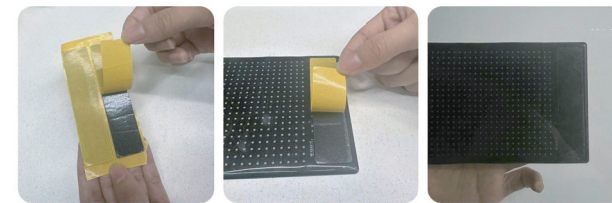

• Clean thoroughly the back of the panel and the surface removing dust, dirt, and debris.
• Apply the double-sided tape evenly on the back of the panel, ensuring it sticks well across the entire surface.
• Position the panel carefully in the desired location and press the panel firmly against the surface for about 5-8 seconds to ensure strong adhesion.

13

14- Product accessories

- App smart screen x1.
- Double-sided foam tape x1.
- USB data cable x1.
- User Manual x1.

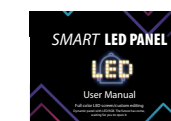
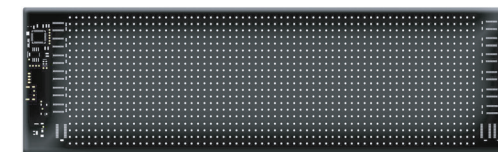

14

15- Product parameters

Product material: PU + FPCB
Product color: BLACK
Sizes: 70 x 173 mm/512 LED (**Art. 95780**)
92 x 374 mm/1024 LED (**Art. 95781**)
120 X 595 mm/1536 LED (**Art. 95783**)
Connection method: Bluetooth
Power supply: USB
Current voltage: 5V/2A



15